

Written By	R. B. Parmar
Checked by	J. V. Mistry
Approved By	V. M. Shah
Revision	00
Rev./Rel. Dt.	06/05/2009
Page	Page 1 of 2

Drilling spools are designed to allow smooth circulation of mud in well and BOP hook up. Drilling spools usually have the same nominal end connections and the same nominal side outlet connections but it can be different as per the customer requirement.



Drilling spools can be supplied in all standard API 16A sizes and types with any combination of flange or hub sizes, materials grades, pressure rating and PSL level. Each drilling spool is manufactured to the customer's requirements. Welding performed conform to the applicable API standard and the provisions of ASME Section IX. Each spool is drift tested to ensure that access to the well-bore is not restricted.

Basic material of construction is alloy steel. For corrosion resistance, overlays like SS 316L or Inconel 625 can be incorporated to improve product life if required.

Unless otherwise specified, each drilling spool is manufactured to the minimum length needed for clamp and/or bolting clearances. Enough clearance on the side outlets ensures complete bolt up of fasteners.

The end-to-end dimension for drilling spools shall be the overall height from the bottom face of the bottom connection to the top face of the top connection.

Rated working pressure

The rated working pressure of the drilling spool shall be the lowest rating of the end / side outlet connectors.

End and outlet connectors

End and side outlet connectors may flanged, studded, threaded, hub or other as per API 6A / API 16A.

Note: This is for understanding only. Please refer to JVS for detailed design & technical information.

Product range

Size : As per customer requirement
 Pressure Class : 2000 PSI to 15000 PSI
 Material of Construction : As per API 16A
 Service Condition : General, Sour Services

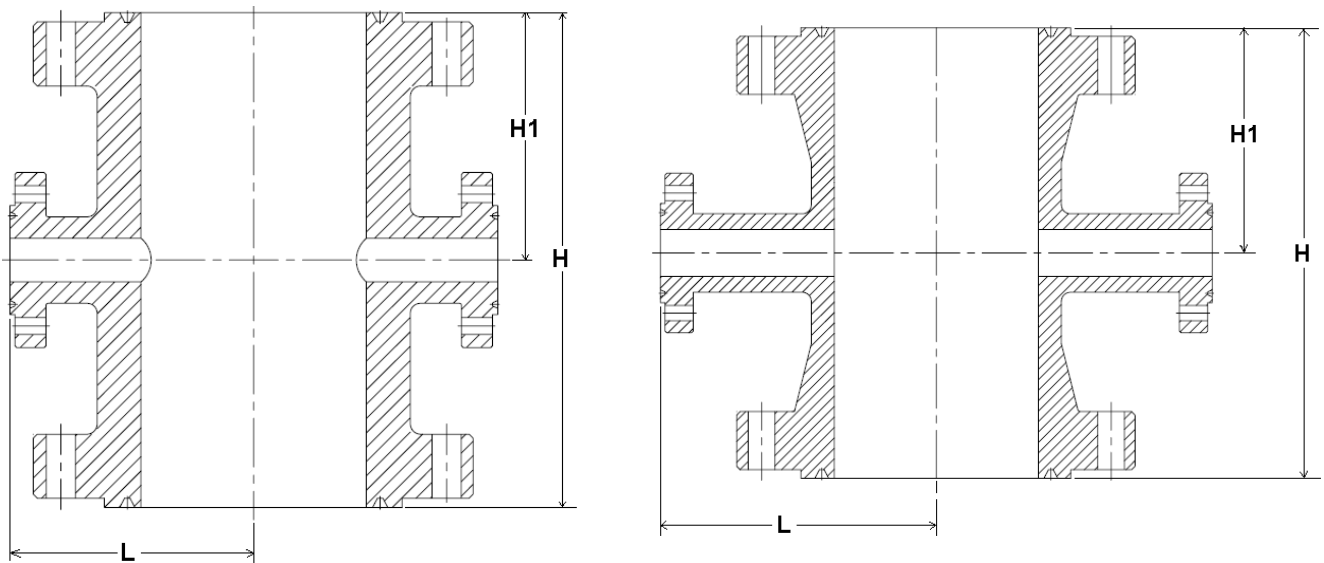

Following Drilling Spool of different sizes and pressure ratings have been manufactured & supplied.

Description	H (mm)	H1 (mm)	L (mm)
7 1/16" X 5M To 7 1/16" X 5M With side outlet 3 1/8" X 5M To 3 1/8" X 5M	660	330	408
11" X 15M To 11" X 15M With side outlet 3 1/16" X 15M To 3 1/16" X 15M	1100	550	450
13 5/8" X 5M To 13 5/8" X 5M With side outlet 2 1/16" X 5M To 2 1/16" X 5M	1524	305	565
13 5/8" X 5M To 13 5/8" X 5M With side outlet 3 1/8" X 5M To 3 1/8" X 5M	700	350	468
13 5/8" X 5M To 13 5/8" X 5M With side outlet 4 1/16" X 5M To 4 1/16" X 5M	700	350	484
13 5/8" X 10M To 13 5/8" X 10M With side outlet 4 1/16" X 10M To 4 1/16" X 10M	980	490	550
20 3/4" X 3M To 20 3/4" X 3M With side outlet 4 1/16" X 5M To 2 1/16" X 5M	636	318	660
20 3/4" X 3M To 21 1/4" X 2M With side outlet 3 1/16" X 10M To 3 1/16" X 10M	2500	800	590
21 1/4" X 2M To 21 1/4" X 2M With side outlet 4 1/16" X 5M To 4 1/16" X 5M	700	350	575
21 1/4" X 2M To 20 3/4" X 3M With side outlet 4 1/16" X 10M To 4 1/16" X 10M	750	375	582

Note: This is for understanding only. Please refer to JVS for detailed design & technical information.