

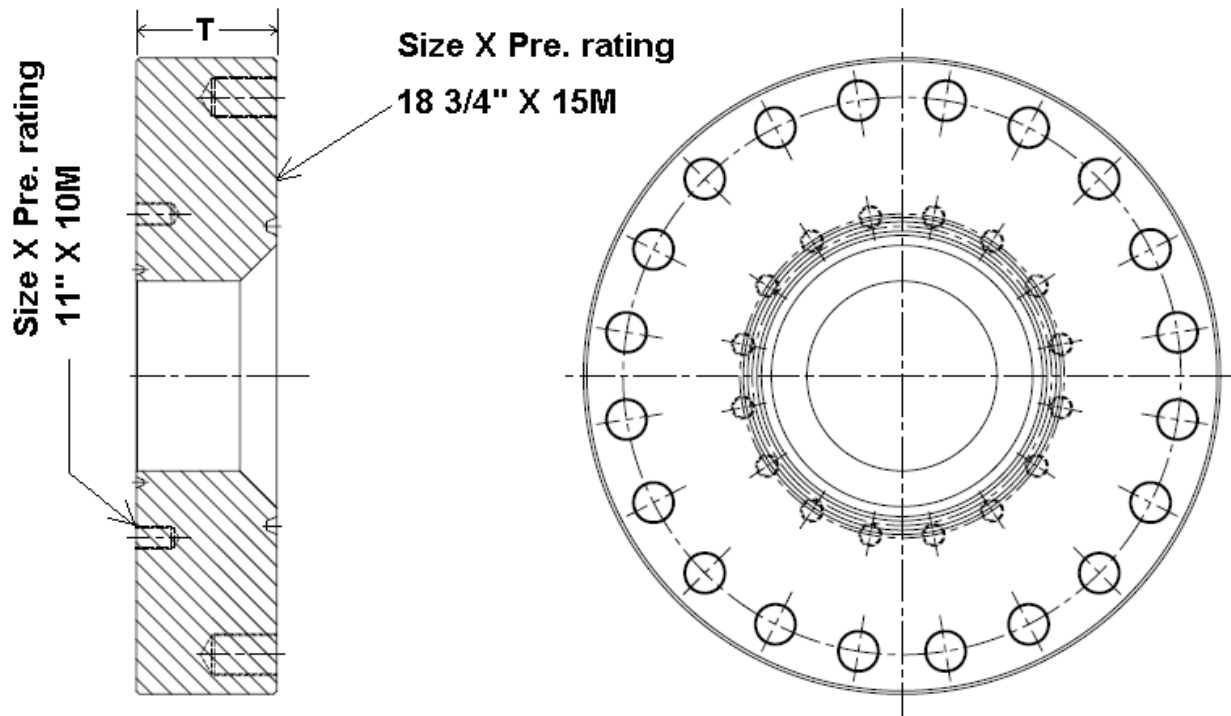

JVS manufactures DSAF in various sizes and pressure ratings. DSAF's are a combination of flanges of different sizes and pressure ratings. DSAF is normally supplied along with appropriate size of studs with nuts duly fitted. Adapter Flanges are used for transition in nominal size and/or pressure rating and where there is a restriction of space in the drill string. They provide an ideal solution by hooking up two different equipments of different size and pressure rating. DSAF's are available as per customer specified thicknesses, consistent with design considerations.

Basic material of construction is alloy steel. For corrosion resistance, overlays like SS 316L or Inconel 625 can be incorporated to improve product life if required.

Example – DSA Flange



Note: This is for understanding only. Please refer to JVS for detailed design & technical information.

Product range

Size : As per customer requirement

Pressure Class : 2000 PSI to 15000 PSI

Material of Construction : As per API 16A

Service Condition : General, Sour Services

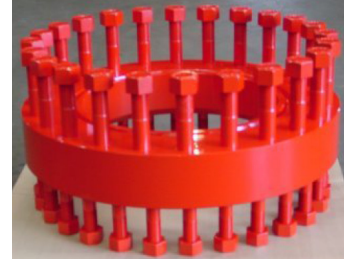

Following DSAF of different sizes and pressure ratings have been manufactured & supplied.

Description (Indicating size & pressure rating)	Flange Thickness (T) mm
2 1/16" X 5M To 3 1/8" X 5M	70
2 1/16" X 10M To 4 1/16" X 10M	80
3 1/16" X 10M To 4 1/16" X 10M	130
3 1/16" X 10M To 4 1/16" X 5M	80
4" X 150# To 6" X 900#	75
4 1/16" X 5M To 2 1/16" X 5M	75
4 1/16" X 5M To 3 1/8" X 5M	83
4 1/16" X 2M To 4 1/16" X 5M	80
7 1/16" X 10M To 13 5/8" X 10M	170
7 1/16" X 5M To 13 5/8" X 5M	150
7 1/16" X 2M To 8" X 600#	75
11" X 15M To 18 3/4" X 15M	256
11" X 5M To 13 5/8" X 5M	144
13 5/8" X 10M To 11" X 10M	267
13 5/8" X 3M To 16 3/4" X 2M	150
13 5/8" X 10M To 18 3/4" X 15M	256
13 5/8" X 5M To 18 3/4" X 15M	256
18 3/4" X 15M To 20 3/4" X 3M	270
20 3/4" X 3M To 18 3/4" X 15M	256
21 1/4" X 2M To 18 3/4" X 15M	256
26 3/4" X 3M To 20 1/4" X 3M	200
26 3/4" X 3M To 21 1/4" X 2M	200
30" X 300# To 21 1/4" X 2M	175
30" X 1M To 26 3/4" X 3M	200

Note: This is for understanding only. Please refer to JVS for detailed design & technical information.